

Application for a premises licence to be granted under the Licensing Act 2003

PLEASE READ THE FOLLOWING INSTRUCTIONS FIRST

Before completing this form please read the guidance notes at the end of the form. If you are completing this form by hand please write legibly in block capitals. In all cases ensure that your answers are inside the boxes and written in black ink. Use additional sheets if necessary.

You may wish to keep a copy of the completed form for your records.

I/We Blue Diamond UK Limited

(Insert name(s) of applicant)

apply for a premises licence under section 17 of the Licensing Act 2003 for the premises described in Part 1 below (the premises) and I/we are making this application to you as the relevant licensing authority in accordance with section 12 of the Licensing Act 2003

Part 1 – Premises details

Postal address of premises or, if none, ordnance survey map reference or description			
Harlow Garden Centre Canes Lane Hastingwood Nr Harlow			
Post town	Essex	Postcode	CM17 9LD
Telephone number at premises (if any)			
Non-domestic rateable value of premises		£188,000	

Part 2 - Applicant details

- | | |
|---|--|
| Please state whether you are applying for a premises licence as | Please tick as appropriate |
| a) an individual or individuals * | <input type="checkbox"/> please complete section (A) |
| b) a person other than an individual * | |
| i as a limited company/limited liability partnership | X please complete section (B) |
| ii as a partnership (other than limited liability) | <input type="checkbox"/> please complete section (B) |
| iii as an unincorporated association or | <input type="checkbox"/> please complete section (B) |
| iv other (for example a statutory corporation) | <input type="checkbox"/> please complete section (B) |
| c) a recognised club | <input type="checkbox"/> please complete section (B) |
| d) a charity | <input type="checkbox"/> please complete section (B) |
| e) the proprietor of an educational establishment | <input type="checkbox"/> please complete section (B) |
| f) a health service body | <input type="checkbox"/> please complete section (B) |

- g) a person who is registered under Part 2 of the Care Standards Act 2000 (c14) in respect of an independent hospital in Wales please complete section (B)
- ga) a person who is registered under Chapter 2 of Part 1 of the Health and Social Care Act 2008 (within the meaning of that Part) in an independent hospital in England please complete section (B)
- h) the chief officer of police of a police force in England and Wales please complete section (B)

* If you are applying as a person described in (a) or (b) please confirm (by ticking yes to one box below):

I am carrying on or proposing to carry on a business which involves the use of the premises for licensable activities; or

I am making the application pursuant to a statutory function or

a function discharged by virtue of Her Majesty's prerogative

(A) INDIVIDUAL APPLICANTS (fill in as applicable)

M <input type="checkbox"/>	Mr <input type="checkbox"/>	Mrs <input type="checkbox"/>	Miss <input type="checkbox"/>	Ms <input type="checkbox"/>	Other Title (for example, Rev)	
Surname				First names		
Date of birth		I am 18 years old or over <input type="checkbox"/>		Please tick yes		
Nationality						
Current residential address if different from premises address						
Post town				Postcode		
Daytime contact telephone number						
E-mail address (optional)						
Where applicable (if demonstrating a right to work via the Home Office online right to work checking service), the 9-digit 'share code' provided to the applicant by that service (please see note 15 for information)						

SECOND INDIVIDUAL APPLICANT (if applicable)

Mr <input type="checkbox"/>	Mrs <input type="checkbox"/>	Miss <input type="checkbox"/>	Ms <input type="checkbox"/>	Other Title (for example, Rev)	
Surname			First names		
Date of birth		I am 18 years old or over		<input type="checkbox"/> Please tick yes	
Nationality					
Where applicable (if demonstrating a right to work via the Home Office online right to work checking service), the 9-digit 'share code' provided to the applicant by that service: (please see note 15 for information)					
Current residential address if different from premises address					
Post town		Postcode			
Daytime contact telephone number					
E-mail address (optional)					

(B) OTHER APPLICANTS

Please provide name and registered address of applicant in full. Where appropriate please give any registered number. In the case of a partnership or other joint venture (other than a body corporate), please give the name and address of each party concerned.

Name Blue Diamond UK Limited
Address Bambridge Park Garden Centre Kiln Lane Eastleigh Hampshire SO50 6HT
Registered number (where applicable) 2421720
Description of applicant (for example, partnership, company, unincorporated association etc.) Limited Company
Telephone number (if any)
E-mail address (optional)

Part 3 Operating Schedule

When do you want the premises licence to start?

DD	MM	YYYY
0	4	09 2 0 1 9

If you wish the licence to be valid only for a limited period, when do you want it to end?

DD	MM	YYYY

Please give a general description of the premises (please read guidance note 1)

These premises trade as an established garden centre with indoor and outdoor retail sales areas. The Tea Room offers hot and cold food throughout the day and an outside terrace is available for customers use in good weather.

Off sales of alcohol are planned from the covered retail shop floor and consumption of alcohol is anticipated in the restaurant and outside terrace.

The layout of the premises is shown on the plan provided with the area to be licensed outlined in red.

If 5,000 or more people are expected to attend the premises at any one time, please state the number expected to attend.

What licensable activities do you intend to carry on from the premises?

(please see sections 1 and 14 and Schedules 1 and 2 to the Licensing Act 2003)

Provision of regulated entertainment (please read guidance note 2)

Please tick all that apply

- a) plays (if ticking yes, fill in box A)
- b) films (if ticking yes, fill in box B)
- c) indoor sporting events (if ticking yes, fill in box C)
- d) boxing or wrestling entertainment (if ticking yes, fill in box D)
- e) live music (if ticking yes, fill in box E)
- f) recorded music (if ticking yes, fill in box F)
- g) performances of dance (if ticking yes, fill in box G)
- h) anything of a similar description to that falling within (e), (f) or (g) (if ticking yes, fill in box H)

Provision of late night refreshment (if ticking yes, fill in box I)

Supply of alcohol (if ticking yes, fill in box J)

X

In all cases complete boxes K, L and M

A

Plays Standard days and timings (please read guidance note 7)			Will the performance of a play take place indoors or outdoors or both – please tick (please read guidance note 3)	Indoors	<input type="checkbox"/>			
				Outdoors	<input type="checkbox"/>			
				Both	<input type="checkbox"/>			
Day	Start	Finish	Please give further details here (please read guidance note 4)					
Mon								
Tue								
Wed						State any seasonal variations for performing plays (please read guidance note 5)		
Thur								
Fri						Non standard timings. Where you intend to use the premises for the performance of plays at different times to those listed in the column on the left, please list (please read guidance note 6)		
Sat								
Sun								

B

Films Standard days and timings (please read guidance note 7)			Will the exhibition of films take place indoors or outdoors or both – please tick (please read guidance note 3)	Indoors	<input type="checkbox"/>
				Outdoors	<input type="checkbox"/>
				Both	<input type="checkbox"/>
Day	Start	Finish	Please give further details here (please read guidance note 4)		
Mon					
Tue			State any seasonal variations for the exhibition of films (please read guidance note 5)		
Wed					
Thur			Non standard timings. Where you intend to use the premises for the exhibition of films at different times to those listed in the column on the left, please list (please read guidance note 6)		
Fri					
Sat					
Sun					

C

Indoor sporting events Standard days and timings (please read guidance note 7)			<u>Please give further details</u> (please read guidance note 4)
Day	Start	Finish	
Mon			<u>State any seasonal variations for indoor sporting events</u> (please read guidance note 5)
Tue			
Wed			
Thur			<u>Non standard timings. Where you intend to use the premises for indoor sporting events at different times to those listed in the column on the left, please list</u> (please read guidance note 6)
Fri			
Sat			
Sun			

D

Boxing or wrestling entertainments Standard days and timings (please read guidance note 7)			<u>Will the boxing or wrestling entertainment take place indoors or outdoors or both – please tick</u> (please read guidance note 3)	
Day	Start	Finish	Indoors	<input type="checkbox"/>
			Outdoors	<input type="checkbox"/>
			Both	<input type="checkbox"/>
Mon			<u>Please give further details here</u> (please read guidance note 4)	
Tue				
Wed			<u>State any seasonal variations for boxing or wrestling entertainment</u> (please read guidance note 5)	
Thur				
Fri				
Sat			<u>Non standard timings. Where you intend to use the premises for boxing or wrestling entertainment at different times to those listed in the column on the left, please list</u> (please read guidance note 6)	
Sun				

E

Live music Standard days and timings (please read guidance note 7)			Will the performance of live music take place indoors or outdoors or both – please tick (please read guidance note 3)	Indoors	<input type="checkbox"/>
				Outdoors	<input type="checkbox"/>
				Both	<input type="checkbox"/>
Day	Start	Finish			
Mon			Please give further details here (please read guidance note 4)		
Tue					
Wed			State any seasonal variations for the performance of live music (please read guidance note 5)		
Thur					
Fri			Non standard timings. Where you intend to use the premises for the performance of live music at different times to those listed in the column on the left, please list (please read guidance note 6)		
Sat					
Sun					

F

Recorded music Standard days and timings (please read guidance note 7)			Will the playing of recorded music take place indoors or outdoors or both – please tick (please read guidance note 3)	Indoors	<input type="checkbox"/>
				Outdoors	<input type="checkbox"/>
				Both	<input type="checkbox"/>
Day	Start	Finish			
Mon			Please give further details here (please read guidance note 4)		
Tue					
Wed			State any seasonal variations for the playing of recorded music (please read guidance note 5)		
Thur					
Fri			Non standard timings. Where you intend to use the premises for the playing of recorded music at different times to those listed in the column on the left, please list (please read guidance note 6)		
Sat					
Sun					

G

Performances of dance Standard days and timings (please read guidance note 7)			<u>Will the performance of dance take place indoors or outdoors or both – please tick</u> (please read guidance note 3)		Indoors	<input type="checkbox"/>
					Outdoors	<input type="checkbox"/>
					Both	<input type="checkbox"/>
Day	Start	Finish	<u>Please give further details here</u> (please read guidance note 4)			
Mon						
Tue			<u>State any seasonal variations for the performance of dance</u> (please read guidance note 5)			
Wed						
Thur			<u>Non standard timings. Where you intend to use the premises for the performance of dance at different times to those listed in the column on the left, please list</u> (please read guidance note 6)			
Fri						
Sat						
Sun						

H

Anything of a similar description to that falling within (e), (f) or (g) Standard days and timings (please read guidance note 7)			Please give a description of the type of entertainment you will be providing			
Day	Start	Finish	<u>Will this entertainment take place indoors or outdoors or both – please tick</u> (please read guidance note 3)		Indoors	<input type="checkbox"/>
Mon					Outdoors	<input type="checkbox"/>
					Both	<input type="checkbox"/>
Tue			<u>Please give further details here</u> (please read guidance note 4)			
Wed						
Thur			<u>State any seasonal variations for entertainment of a similar description to that falling within (e), (f) or (g)</u> (please read guidance note 5)			
Fri						
Sat						
Sun			<u>Non standard timings. Where you intend to use the premises for the entertainment of a similar description to that falling within (e), (f) or (g) at different times to those listed in the column on the left, please list</u> (please read guidance note 6)			

I

Late night refreshment Standard days and timings (please read guidance note 7)			Will the provision of late night refreshment take place indoors or outdoors or both – please tick (please read guidance note 3)	Indoors	
				Outdoors	<input type="checkbox"/>
				Both	<input type="checkbox"/>
Day	Start	Finish	Please give further details here (please read guidance note 4)		
Mon					
Tue					
Wed					
Thur					
Fri					
Sat					
Sun					
			State any seasonal variations for the provision of late night refreshment (please read guidance note 5)		
			Non standard timings. Where you intend to use the premises for the provision of late night refreshment at different times, to those listed in the column on the left, please list (please read guidance note 6)		

J

Supply of alcohol Standard days and timings (please read guidance note 7)			Will the supply of alcohol be for consumption – please tick (please read guidance note 8)	On the premises	
				Off the premises	<input type="checkbox"/>
				Both	<input checked="" type="checkbox"/>
Day	Start	Finish	State any seasonal variations for the supply of alcohol (please read guidance note 5)		
Mon	08.30	18.00			
Tue	08.30	18.00			
Wed	08.30	18.00			
Thur	08.30	18.00			
Fri	08.30	18.00			
Sat	08.30	18.00			
Sun	10.00	16.30			
			Non standard timings. Where you intend to use the premises for the supply of alcohol at different times to those listed in the column on the left, please list (please read guidance note 6)		

State the name and details of the individual whom you wish to specify on the licence as designated premises supervisor (Please see declaration about the entitlement to work in the checklist at the end of the form):

Name		[REDACTED]
Date of birth		
Address		
[REDACTED]		
Postcode	[REDACTED]	
Personal licence number (if known)		
[REDACTED]		
Issuing licensing authority (if known)		
[REDACTED]		

K

Please highlight any adult entertainment or services, activities, other entertainment or matters ancillary to the use of the premises that may give rise to concern in respect of children (please read guidance note 9).
None

L

Hours premises are open to the public Standard days and timings (please read guidance note 7)			State any seasonal variations (please read guidance note 5)
Day	Start	Finish	<u>Non standard timings. Where you intend the premises to be open to the public at different times from those listed in the column on the left, please list</u> (please read guidance note 6)
Mon	08.30	18.00	
Tue	08.30	18.00	
Wed	08.30	18.00	
Thur	08.30	18.00	
Fri	08.30	18.00	
Sat	08.30	18.00	
Sun	10.00	16.30	

M

Describe the steps you intend to take to promote the four licensing objectives:

a) General – all four licensing objectives (b, c, d and e) (please read guidance note 10)

The premises license holder, or the person appointed to be in charge of the premises when licensable activity is taking place, shall provide or have the unhampered use of a telephone on the premises for use in an emergency.

b) The prevention of crime and disorder

Alcohol shall not be sold in an open container by way of off sales

A written incident record shall be maintained at the premises to record all incidents in respect to crime and disorder. The incident record shall be available to Police upon request

The Licensee shall maintain an efficient closed circuit television (CCTV) surveillance system to the satisfaction of the Police Licensing Department. The CCTV shall include camera coverage of the alcohol display area as well as the entrances and exits.

A suitably worded sign of sufficient size and clarity shall be displayed at the entrance to the premises and in the alcohol display area, advising patrons that CCTV is operating within the premises.

c) Public safety

The applicants will ensure that all fire safety and other safety equipment is properly maintained.

d) The prevention of public nuisance

e) The protection of children from harm

The Licensee shall operate a "Challenge 25" scheme on the premises whereby those persons attempting to buy alcohol who appear to be under 25 years of age will be required to prove they are 18 years of age or older. Acceptable proof of age shall consist of passport, photographic driving licence or proof of age cards with the "PASS" logo.

The Licensee shall ensure that all staff are adequately trained on age identification.

Written staff training records for all staff engaged in the sale of alcohol shall be maintained by the licensee and retained on the premises.

Checklist:

Please tick to indicate agreement

- I have made or enclosed payment of the fee. X
- I have enclosed the plan of the premises. X
- I have sent copies of this application and the plan to responsible authorities and others where applicable.
- I have enclosed the consent form completed by the individual I wish to be designated premises supervisor, if applicable. X
- I understand that I must now advertise my application. X
- I understand that if I do not comply with the above requirements my application will be rejected. X
- [Applicable to all individual applicants, including those in a partnership which is not a limited liability partnership, but not companies or limited liability partnerships] I have included documents demonstrating my entitlement to work in the United Kingdom or my share code issued by the Home Office online right to work checking service (please read note 15).

IT IS AN OFFENCE, UNDER SECTION 158 OF THE LICENSING ACT 2003, TO MAKE A FALSE STATEMENT IN OR IN CONNECTION WITH THIS APPLICATION. THOSE WHO MAKE A FALSE STATEMENT MAY BE LIABLE ON SUMMARY CONVICTION TO A FINE OF ANY AMOUNT.

IT IS AN OFFENCE UNDER SECTION 24B OF THE IMMIGRATION ACT 1971 FOR A PERSON TO WORK WHEN THEY KNOW, OR HAVE REASONABLE CAUSE TO BELIEVE, THAT THEY ARE DISQUALIFIED FROM DOING SO BY REASON OF THEIR IMMIGRATION STATUS. THOSE WHO EMPLOY AN ADULT WITHOUT LEAVE OR WHO IS SUBJECT TO CONDITIONS AS TO EMPLOYMENT WILL BE LIABLE TO A CIVIL PENALTY UNDER SECTION 15 OF THE IMMIGRATION, ASYLUM AND NATIONALITY ACT 2006 AND PURSUANT TO SECTION 21 OF THE SAME ACT, WILL BE COMMITTING AN OFFENCE WHERE THEY DO SO IN THE KNOWLEDGE, OR WITH REASONABLE CAUSE TO BELIEVE, THAT THE EMPLOYEE IS DISQUALIFIED.

Part 4 – Signatures (please read guidance note 11)

Signature of applicant or applicant’s solicitor or other duly authorised agent (see guidance note 12). If signing on behalf of the applicant, please state in what capacity.

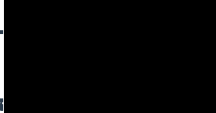
Declaration	<ul style="list-style-type: none"> • [Applicable to individual applicants only, including those in a partnership which is not a limited liability partnership] I understand I am not entitled to be issued with a licence if I do not have the entitlement to live and work in the UK (or if I am subject to a condition preventing me from doing work relating to the carrying on of a licensable activity) and that my licence will become invalid if I cease to be entitled to live and work in the UK (please read guidance note 15). • The DPS named in this application form is entitled to work in the UK (and is not subject to conditions preventing him or her from doing work relating to a licensable activity) and I have seen a copy of his or her proof of entitlement to work, or have conducted an online right to work check using the Home Office online right to work checking service which confirmed their right to work (please see note 15)
Signature	 Karen Pownall
Date	07/08/2019
Capacity	Authorised Agent

For joint applications, signature of 2nd applicant or 2nd applicant’s solicitor or other authorised agent (please read guidance note 13). If signing on behalf of the applicant, please state in what capacity.

Signature	
Date	
Capacity	

Contact name (where not previously given) and postal address for correspondence associated with this application (please read guidance note 14) Melrose Group 8 St Mary Street Thornbury			
Post town	Bristol	Postcode	BS35 2AB
Telephone number (if any)	01454 419262 ext 5		
If you would prefer us to correspond with you by e-mail, your e-mail address (optional) licensing@melrosegroupp.co.uk			

Notes for Guidance

1. Describe the premises, for example the type of premises, its general situation and layout and any other information which could be relevant to the licensing objectives. Where your application includes off-supplies of alcohol and you intend to provide a place for consumption of these off-supplies, you must include a description of where the place will be and its proximity to the premises.
2. In terms of specific regulated entertainments please note that:
 - Plays: no licence is required for performances between 08:00 and 23.00 on any day, provided that the audience does not exceed 500.
 - Films: no licence is required for 'not-for-profit' film exhibition held in community premises between 08.00 and 23.00 on any day provided that the audience does not exceed 500 and the organiser (a) gets consent to the screening from a person who is responsible for the premises; and (b) ensures that each such screening abides by age classification ratings.
 - Indoor sporting events: no licence is required for performances between 08.00 and 23.00 on any day, provided that the audience does not exceed 1000.
 - Boxing or Wrestling Entertainment: no licence is required for a contest, exhibition or display of Greco-Roman wrestling, or freestyle wrestling between 08.00 and 23.00 on any day, provided that the audience does not exceed 1000. Combined fighting sports – defined as a contest, exhibition or display which combines boxing or wrestling with one or more martial arts – are licensable as a boxing or wrestling entertainment rather than an indoor sporting event.
 - Live music: no licence permission is required for:
 - a performance of unamplified live music between 08.00 and 23.00 on any day, on any premises.
 - a performance of amplified live music between 08.00 and 23.00 on any day on premises authorised to sell alcohol for consumption on those premises, provided that the audience does not exceed 500.

Consent of individual to being specified as premises supervisor

I [redacted] (full name of prospective premises supervisor)
of [redacted]

(home address of prospective premises supervisor)

Date of Birth .. [redacted] ... Place of Birth .. [redacted]

Nationality ... British..... Contact tel. number [redacted] ...

hereby confirm that I give my consent to be specified as the designated premises supervisor in relation to the application for

..... Premises Licence DPS (type of application)

By..... Blue Diamond UK Ltd
..... (name of applicant)

relating to a premises licence NEW..... (number of existing licence, if any)

for ... HARLOW GARDEN, CENTRE, CANES LANE, HASTINGWOOD,
(name and address of premises of which the application relates) NR HARLOW, CM17 9LD

and any premises licence to be granted or varied in respect of this application made

by as above..... (name of applicant)

concerning the supply of alcohol at

..... as above..... (name and address of premises to which application relates).

I also confirm that I am entitled to work in the United Kingdom and am applying for, intend to apply for or currently hold a personal licence, details of which I set out below.

Personal licence number . [redacted]

Personal Licence issuing authority ... Wychavon District Council.....

Signed ... [redacted]

Name (please print) Alan Gisbourne..... Date .. 06/08/2019

HALLWAY

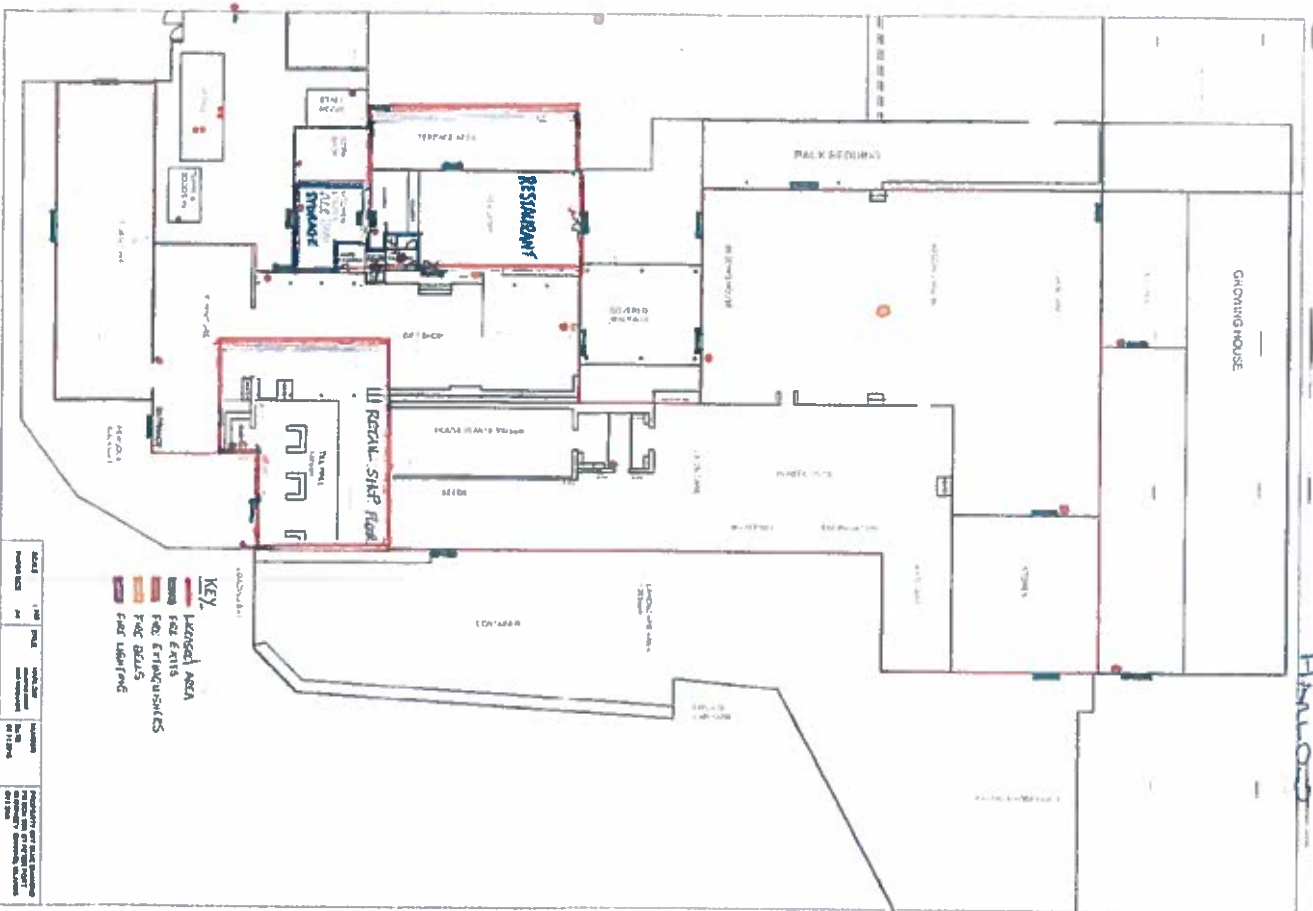

HALLWAY GARAGE CEILING, CANES LADE, HASTRUBOD, CM17 9LD

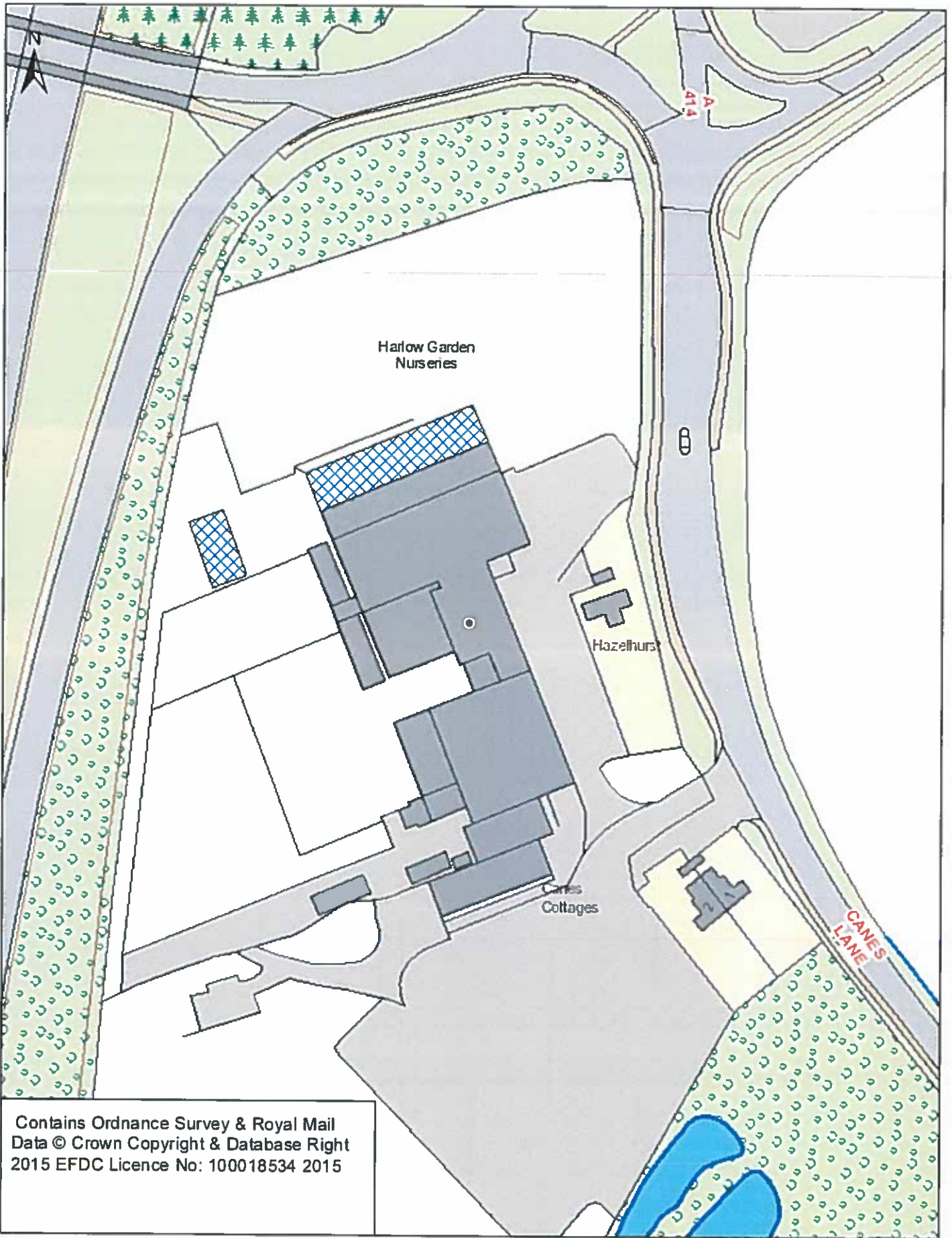

Contains Ordnance Survey & Royal Mail
 Data © Crown Copyright & Database Right
 2015 EFDC Licence No: 100018534 2015

**Notice of Application for a New Premises Licence under
the Licensing Act 2003**

Notice is given that Blue Diamond UK Limited of
Bambridge Park Garden Centre, Kiln Lane, Eastleigh,
SO50 6HT have applied to the Licensing office of Epping
Forest District Council for a Premises Licence in respect of
Harlow Garden Centre, Canes Lane, Hastingwood, Nr
Harlow, CM17 9LD

The proposed licence is for the sale of alcohol for
consumption on and off the premises between 08.30 until
18.00 hrs Monday to Saturday and 10.00 until 16.30 hrs
Sundays, opening hours of the same, all as specified in
the application.

The register of licensed premises is maintained at the
Licensing Office of Epping Forest District Council, Civic
Offices, High Street, Epping, Essex, CM16 4BZ.
Applications for premises licences may be inspected at
this office during office hours. Anyone wishing to oppose
this application must give written notice to the Licensing
Office by 4th September 2019.

It is an offence knowingly or recklessly to make a false
statement in connection with an application which could
lead to a fine on summary conviction (maximum £5000)

ONLY 70p

HARLOW

Guardian

PAMPERED POOCHES AND FABULOUS FELINES

We're searching for the best pet groomers around
NOMINATE YOUR FAVOURITE INSIDE

Trusted news read by 57,259 people every week

Thursday, August 15, 2019

Probe into claim man was 'fired after cancer diagnosis' P9

£100k deal to keep on P5



August 15, 2019

Announcements - Public Notices

**TOWN AND COUNTRY PLANNING ACT 1990
 PLANNING (LISTED BUILDINGS AND CONSERVATION AREAS) ACT 1990
 Planning (Listed Buildings and Conservation Areas) Regulations 1990
 Town and Country Planning
 (Development Plans and Consultation) Directions 1992**

PUBLIC NOTICE OF APPLICATIONS

The following applications have been received by Harlow District Council. These applications and others received can be inspected at Harlow Council Planning Services, Civic Centre, The Water Gardens, Harlow, Essex, CM20 1WG on Monday - Friday, 9am - 4:45pm. If you are unable to view the plans during these times, please telephone Planning Services on (0) 279 448856 where a suitable appointment can be made with the relevant case officer.

Anyone who wishes to make representations about these applications should write to the Council at the above address within 21 days of the date of this notice.

Application No: HW/FUL/19/00298 **Ward:** Little Parndon - Here Street
Application Type: Full Application
Location: Harlow Stadium Stadium Way Harlow Essex
Proposal: Demolition of existing kennels, and construction of a new part one, part three storey building incorporating replacement kennels to accommodate an increased number of greyhounds, offices and overnight accommodation for staff.
Reason for Advert: Local Public Interest



Notice of Application for a New Premises Licence under the Licensing Act 2003

Notice is given that Blue Diamond UK Limited of Brambridge Park Garden Centre, Kiln Lane, Eastleigh, SO50 6HT have applied to the Licensing Office of Epping Forest District Council for a Premises Licence in respect of Harlow Garden Centre, Canes Lane, Hastingwood, Nr Harlow, CM17 9LD. The proposed licence is for the sale of alcohol for consumption on and off the premises between 08.30 until 18.00 hrs Monday to Saturday and 10.00 until 18.30 hrs Sundays, opening hours of the same, all as specified in the application. The register of licensed premises is maintained at the Licensing Office of Epping Forest District Council, Civic Offices, High Street, Epping, Essex, CM16 4BZ. Applications for premises licences may be inspected at this office during office hours. Anyone wishing to oppose this application must give written notice to the Licensing Office by 4th September, 2019. It is an offence knowingly or recklessly to make a false statement in connection with an application which could lead to a fine on summary conviction (maximum £5000)

Public Notices

LELAN LOCKYER (Deceased)
 Pursuant to the Trustee Act 1925 any persons having a claim against or an interest in the Estate of the above named (late of 25) Fowell Court, Prospect Hill, London E17 3EL, who died on 07/02/2019, are required to send written particulars thereof to the undersigned on or before 23/10/2019, after which date the Estate will be distributed having regard only to the claims and interests of which they have had notice.
 Fellowes Solicitors LLP, 21 Church Hill, Welhamstown, London E17 3AD.
 Ref: MSA/ed/yer

IF YOU'RE A PARTY PLANNER WE CAN HELP YOUR BUSINESS TAKE OFF

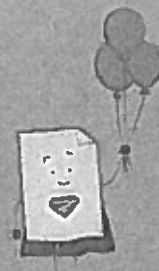

ZOOM-IN
 WHATEVER YOU DO
 CALL 0845 1999 830 OR VISIT
 ZOOMINLEAFLETS.CO.UK

We can reach up to...

35%
 of residents reached across East London & West Essex.*

*Source: Telmar Nov 2018



Guardian

To discuss your requirements:
020 8884 7420
 saleseast@localiq.co.uk
 eppingforestguardian.co.uk
 guardian-series.co.uk

LOC localiq

Travel

Holidays and Tours flying from London Gatwick &

Newmarket

Debbie Houghton

From: Susan De Luca <Clerk@northweald-pc.gov.uk>
Sent: 04 September 2019 15:04
To: Debbie Houghton
Subject: RE: Application for a New Premises Licence - Harlow Garden Centre, Canes Lane, Hastingwood, CM17 9LD

CAUTION: This Message originated outside of Epping Forest District Council. Do not click links or open attachments unless you recognise the sender and know the contents is safe.

Good Afternoon Debbie

This is to confirm that the Parish Council Objects to the Alcohol Licence for Harlow Garden Centre.

This is due to Members concerns regarding Public Safety & Public Nuisance.

Kind Regards

Susan De Luca

Clerk to the Council

From: Debbie Houghton <dhoughton@eppingforestdc.gov.uk>
Sent: 04 September 2019 14:52
To: Susan De Luca <Clerk@northweald-pc.gov.uk>
Subject: RE: Application for a New Premises Licence - Harlow Garden Centre, Canes Lane, Hastingwood, CM17 9LD

Thank you 😊

*Miss Debbie Houghton
Licensing Officer
Licensing Team,
Commercial and Regulatory Directorate
Tel: 01992 564336
E-mail: dhoughton@eppingforestdc.gov.uk*

From: Susan De Luca [<mailto:Clerk@northweald-pc.gov.uk>]
Sent: 04 September 2019 14:47
To: Debbie Houghton
Subject: RE: Application for a New Premises Licence - Harlow Garden Centre, Canes Lane, Hastingwood, CM17 9LD

CAUTION: This Message originated outside of Epping Forest District Council. Do not click links or open attachments unless you recognise the sender and know the contents is safe.

Yes I haven't forgotten doing it now – got tied up this morning with Dog Bins

Sue

From: Debbie Houghton <dhoughton@eppingforestdc.gov.uk>
Sent: 04 September 2019 14:44
To: Susan De Luca <Clerk@northweald-pc.gov.uk>
Subject: RE: Application for a New Premises Licence - Harlow Garden Centre, Canes Lane, Hastingwood, CM17 9LD

Good afternoon Susan,

I have been forwarded your email that went to Denise, after speaking with you this morning I am still waiting for your representation to be sent to me with the correct wording, is there a chance that I might get this before 16.00 as I will be leaving then and I have a report for committee to do,

Many thanks
Debbie

Miss Debbie Houghton
Licensing Officer
Licensing Team,
Commercial and Regulatory Directorate
Tel: 01992 564336
E-mail: dhoughton@eppingforestdc.gov.uk

From: Susan De Luca [<mailto:Clerk@northweald-pc.gov.uk>]
Sent: 04 September 2019 09:44
To: Debbie Houghton
Subject: Fwd: Application for a New Premises Licence - Harlow Garden Centre, Canes Lane, Hastingwood, CM17 9LD

CAUTION: This Message originated outside of Epping Forest District Council. Do not click links or open attachments unless you recognise the sender and know the contents is safe.

Sent from my iPad

Begin forwarded message:

From: Susan De Luca <Clerk@northweald-pc.gov.uk>
Date: 2 September 2019 at 23:55:38 BST
To: Denise Bastick <dbastick@eppingforestdc.gov.uk>
Subject: Re: Application for a New Premises Licence - Harlow Garden Centre, Canes Lane, Hastingwood, CM17 9LD

Hello Denise

I wish to advise that `members OBJECTED to this licence as they felt a Garden was not an appropriate place for alcohol to be sold.

Kind Regards
Susan Deluca
Clerk to the Council

Sent from my iPad

On 8 Aug 2019, at 10:32, Denise Bastick <dbastick@eppingforestdc.gov.uk> wrote:

Good Morning

Please find attached a new premises licence application for the above premises. The application is for the sale of alcohol, both on and off the premises.

Hours Open to the Public

Monday to Saturday 08:30 to 18:00

Sunday 10:00 to 16:30

Supply of Alcohol

Monday to Saturday 08:30 to 18:00

Sunday 10:00 to 16:30

both on and off the premises

The start date of the consultation is **8th August 2019**, end of consultation will be **4th September 2019**. Please let us have any comments or objections by then. The Officer dealing with this application will be Debbie Houghton.

N.B. This is an unredacted copy and not for public consumption in this format, this will be available on the website shortly.

Kind regards.

Denise Bastick
Licensing Compliance Officer
Commercial and Regulatory Service Directorate
dbastick@eppingforestdc.gov.uk
Tel: 01992 564334
Working hours Wednesday – Friday

Please contact Mrs Handan Ibrahim, Licensing Compliance Officer
hibrahim@eppingforestdc.gov.uk Tel: 01992 564153
Monday – Wednesday



DISCLAIMER

This email is for the use of the intended recipients only. Any opinion or advice it contains is that of the sender and does not bind the authority in any way. If you have received it in error, please notify the sender immediately and then delete the message. If you are not the intended recipient you must not use, disclose, copy or distribute this email. We have taken precautions to minimise the risk of transmitting software viruses, but we advise that you carry out your own virus checks on an attachment to this message. We cannot accept liability for any loss or damage caused by software viruses.

Internet email is not a secure communication medium, and we advise that you observe this lack of security when emailing us.

Epping Forest District Council
Postmaster@Eppingforestdc.gov.uk

<Harlow Garden Centre new premises licence application.pdf>

<Harlow Garden Centre DPS Alan Gisbourne.pdf>

<Harlow Garden Centre plan.pdf>

Harlow Garden Centre – Conditions Sought

1. The premises will have installed and maintained a closed circuit television surveillance (CCTV) system which at all times complies with the below requirements:
 - i. CCTV will be provided in the form a recordable system, capable of providing pictures of evidential quality in all lighting conditions particularly facial recognition;
 - ii. CCTV cameras will cover all public areas including all entrances and exits and all areas where the sale of alcohol takes place;
 - iii. Equipment will be maintained in good working order, be correctly time and date stamped, recordings must be kept in good working order and kept for a minimum period of 31 days;
 - iv. At all times, whilst the premises is open for licensable activities, there are members of staff able to immediately provide viewable copies of recordings to the police or licensing authority staff upon reasonable request;
 - v. The recording equipment and data storage devices will be kept in a secure environment and fitted with security functions (such as passwords) to prevent recordings being tampered with;
 - vi. An operational daily log report will be maintained endorsed by signature, indicating the system has been checked and is compliant: in the event of any failure this will be recorded immediately.
2. Signs must be displayed at all entrances advising customers that CCTV is operating at the premises and will be a minimum size of 200x148mm and clearly legible at all times when the premises conducts licensable activities.
3. No alcohol may be supplied by an individual unless that individual has the written consent of the Designated Premises Supervisor or other employed Personal Licence Holder. A written record of this consent must be retained on the premises at all times when such an individual supplies or proposes to supply alcohol and be made available immediately upon reasonable request of the police or licensing authority.
4. The sale of alcohol for consumption **ON** the premises must only be to customers seated at a table and ancillary to a substantial table meal.
5. In addition to water, other non-alcoholic beverages will be available at all times whilst alcohol sale or supply takes place.
6. A Challenge 25 scheme will be operated, whereby any person who appears to be under the age of 25 years of age is required to produce on request an item which meets the mandatory age verification requirement **and** is either a:
 - Proof of age card bearing the PASS Hologram;
 - Photocard driving licence;
 - Passport; or
 - Ministry of Defence Identity Card.
7. The premises will clearly display signs advising customers that a 'Challenge 25' policy is in force.

Debbie Houghton

From: Licensing Epping and Brentwood
<licensing.epping.and.brentwood@essex.police.uk>
Sent: 03 September 2019 12:34
To: Licensing; Licensing Epping and Brentwood
Cc: Licensing
Subject: RE: Harlow Garden Centre - Application for Premises Licence
Attachments: Harlow Garden Centre - Conditions Sought.docx

CAUTION: This Message originated outside of Epping Forest District Council. Do not click links or open attachments unless you recognise the sender and know the contents is safe.

Good afternoon; and thank you for your response. Essex Police are happy to negotiate and agree the amendment to the wording of condition 4.

Mrs Houghton – Please accept this email as an agreed position. Essex Police make no formal representations to the application.

Kind regards,

Peter



Peter Jones (7706) MIOL MBII
Licensing Officer – Epping Forest & Harlow
☎ 01279625405 (Ext: 313604) ☎ 07870909762
📍 Loughton Police Station, 158 High Road, Loughton, IG104BE

From: Licensing <Licensing@melrosegroupp.co.uk>
Sent: 03 September 2019 11:48
To: Licensing Epping and Brentwood <licensing.epping.and.brentwood@essex.police.uk>; Licensing <Licensing@melrosegroupp.co.uk>
Cc: EFDC Licensing <licensing@eppingforestdc.gov.uk>
Subject: RE: Harlow Garden Centre - Application for Premises Licence

Good morning Peter

Apologies again for the late response and thank you for being so patient.

Our client has now been in contact with regards to your suggested conditions (attached). I am pleased to confirm we are happy to accept them all, as worded, with just one exception, condition 4 'The sale of alcohol for consumption ON the premises must only be to customers seated at a table and ancillary to a substantial table meal'.

The restaurant will be primarily food driven, family friendly premises, however many customers may only want a light snack, sandwich or indeed nothing to eat at all if accompanying friends or family. Would you be content with the following reworded condition in place of your suggested condition? 'The consumption of alcohol on the premises shall be restricted to customers seated at a table'.

We do hope the above meets with your approval and we can avoid the need for a hearing on this matter?

Many thanks.

Kind Regards.

Karen Pownall